

Camera #	Camera Type	Mounting Structure	Location	View	Corridor Mode	Notes
C-01	C1	WALL	N.W. CORNER	WEST DOORS, STREET & PARKING	N	WALLARM, CORNER MOUNT
C-02	C2	WALL	N.E. CORNER	GARAGE DOORS & PARKING	N	
C-03	C1	WALL	N. CORNER	GARAGE DOOR, MAN DOOR & PARKING	N	WALLARM, CORNER MOUNT
C-04	C1	WALL	N.E. CORNER	GARAGE DOORS & PARKING	N	WALLARM, CORNER MOUNT
C-05	C2	WALL	SOUTH CORNER	GARAGE DOOR, MAN DOOR & PARKING	N	
C-06	C2	WALL	NORTH CORNER	MAN DOOR & PARKING	N	
C-07	C1	WALL	NORTH CORNER	MAN DOOR & PARKING	N	WALLARM, CORNER MOUNT
C-08	C1	WALL	SOUTH CORNER	MAN DOOR & PARKING	N	WALLARM, CORNER MOUNT
C-09	C2	WALL	EAST CORNER	MAN DOOR & PARKING	N	
C-10	C2	WALL	SOUTH CORNER	MAN DOOR & PARKING	N	
C-11	C1	WALL	NORTH CORNER	MAN DOOR & PARKING	N	WALLARM, CORNER MOUNT
C-12	C1	WALL	N.W. CORNER	GARAGE DOOR, MAN DOOR & PARKING	N	WALLARM, CORNER MOUNT
C-13	C2	WALL	S.W. CORNER	MAN DOOR & PARKING	N	
C-14	C1	WALL	NORTH SIDE	GARAGE DOORS & PARKING	N	WALLARM, CORNER MOUNT
C-15	C1	WALL	NORTH SIDE	MAN DOOR & PARKING	N	WALLARM, CORNER MOUNT
C-16	C1	WALL	N.E. CORNER	MAN DOOR & PARKING	N	WALLARM, CORNER MOUNT
C-17	C1	WALL	EAST SIDE	MAN DOOR & PARKING	N	WALLARM, CORNER MOUNT
C-18	C3	WALL	EAST SIDE	PARKING	N	WALLARM, PENDANT CAP
C-19	C1	WALL	S.E. CORNER	PARKING	N	WALLARM, CORNER MOUNT
C-20	C1	WALL	SOUTH SIDE	MAN DOOR & PARKING	N	WALLARM, CORNER MOUNT
C-21	C3	WALL	SOUTH SIDE	MAN DOOR & PARKING	N	WALLARM, PENDANT CAP
C-22	C1	WALL	N.E. CORNER	GARAGE DOOR, PARKING	N	WALLARM, CORNER MOUNT
C-23	C1	WALL	SOUTH SIDE	MAN DOOR & PARKING	N	WALLARM, CORNER MOUNT
C-24	C1	WALL	S.W. CORNER	GARAGE DOOR, MAN DOOR & PARKING	N	WALLARM, CORNER MOUNT
C-25	C3	WALL	WEST SIDE	GARAGE DOORS & PARKING	N	WALLARM, PENDANT CAP
C-26	C4	CEILING	INTERIOR	CORR. 107, NORTH	N	
C-27	C4	CEILING	INTERIOR	VESTIBULE 100, NORTH	N	
C-28	C4	CEILING	INTERIOR	VESTIBULE 100, SOUTH	N	
C-29	C4	CEILING	INTERIOR	TRAINING ROOM 108, NORTH	N	
C-30	C4	CEILING	INTERIOR	TRAINING ROOM 108, SOUTH	N	
C-31	C4	CEILING	INTERIOR	CORR. 107, SOUTH	N	
C-32	C5	WALL	SOUTH SIDE	MAN DOOR & PARKING	N	
C-33	C6	CEILING	INTERIOR	TREATMENT ROOM 102	N	
C-34	C6	CEILING	INTERIOR	EMS STORAGE ROOM 172	N	
C-35	C1	WALL	EAST CORNER	GARAGE DOOR, PARKING	N	WALLARM, PENDANT CAP
C-36	C1	WALL	S.E. CORNER	GARAGE DOOR, PARKING	N	WALLARM, PENDANT CAP
C-37	C1	POLE	PARKING LOT	PARKING LOT	N	WALLARM, PENDANT CAP

**1 CAMERA SCHEDULE**

Camera Type	Manufacturer	Part #	General Description
C1	Hanwha Techwin	PNM-8082VT	6MP (2MP x 3) Multi-Directional Camera
C2	Hanwha Techwin	XNO-6083R	2MP IR Bullet AI Camera
C3	Hanwha Techwin	PNM-9022V	8MP (2MP x 4) 180° Panoramic
C4	Hanwha Techwin	XND-6081RV	2MP Vandal-Resistant Indoor IR Network Dome Camera
C5	Hanwha Techwin	XNV-6080R	2MP Vandal-Resistant Outdoor IR Network Dome Camera
C6	Hanwha Techwin	XNF-8010R	6MP sensor 360° Indoor Fisheye

**2 CAMERA TYPE**

DOOR#	LOCATION OF CR	DEVICE TYPE	DC	REX	NOTES	PATHWAY
D-101	LEFT	MULLION	1	1	PROVIDE ELECTRIC STRIKE WITH PADDLE	EMT
D-102	RIGHT	MULLION	1	1	PROVIDE ELECTRIC STRIKE, CHANGE LOCK TO STOREROOM FUNCTION, ADD DOOR CLOSER	EMT
D-103	LEFT	MULLION	1	1	PROVIDE ELECTRIC STRIKE, CHANGE LOCK TO STOREROOM FUNCTION	EMT
D-104	ON DOOR	WIRELESS	1	1	PROVIDE WIRELESS HUB & APERO INI100-10G77 W/HID MOBILE ACCESS,	EMT
D-105	ON DOOR	WIRELESS	1	1	PROVIDE WIRELESS HUB & APERO INI100-10G77 W/HID MOBILE ACCESS,	EMT
D-106	LEFT	SINGLE GANG	1	1	PROVIDE ELECTRIC STRIKE, CHANGE LOCK TO STOREROOM FUNCTION	EMT
D-107	LEFT	SINGLE GANG	1	1	PROVIDE ELECTRIC STRIKE, CHANGE LOCK TO STOREROOM FUNCTION	EMT
D-108	LEFT	SINGLE GANG	1	1	PROVIDE ELECTRIC STRIKE, CHANGE LOCK TO STOREROOM FUNCTION	EMT
D-109	RIGHT	MULLION	1	1	PROVIDE RIM STRIKE ON REMOVEABLE MULLION W/ TRIME MWH-5 HARNESS	EMT
D-110	RIGHT	SINGLE GANG	1	1	PROVIDE ELECTRIC STRIKE, CHANGE LOCK TO STOREROOM FUNCTION.	EMT
D-111	LEFT	SINGLE GANG	1	1	PROVIDE ELECTRIC STRIKE WITH PADDLE	EMT
D-112	LEFT	SINGLE GANG	1	1	PROVIDE ELECTRIC STRIKE, CHANGE LOCK TO STOREROOM FUNCTION.	EMT
D-113	ON DOOR	WIRELESS	1	1	PROVIDE WIRELESS HUB & APERO INI100-10G77 W/HID MOBILE ACCESS,	EMT
D-114	LEFT	SINGLE GANG	1	1	DOOR HARDWARE & PATHWAYS BY OTHERS. MAKE FINAL CONNECTION TO LOCK	
D-115	LEFT	SINGLE GANG	1	1	DOOR HARDWARE & PATHWAYS BY OTHERS. MAKE FINAL CONNECTION TO LOCK	
D-116	RIGHT	SINGLE GANG	1	1	DOOR HARDWARE & PATHWAYS BY OTHERS. MAKE FINAL CONNECTION TO LOCK	
D-117	LEFT	SINGLE GANG	1	1	DOOR HARDWARE & PATHWAYS BY OTHERS. MAKE FINAL CONNECTION TO LOCK	
D-118	LEFT	SINGLE GANG	1	1	DOOR HARDWARE & PATHWAYS BY OTHERS. MAKE FINAL CONNECTION TO LOCK	
D-119	RIGHT	SINGLE GANG	1	1	DOOR HARDWARE & PATHWAYS BY OTHERS. MAKE FINAL CONNECTION TO LOCK	
D-120	LEFT	SINGLE GANG	1	1	DOOR HARDWARE & PATHWAYS BY OTHERS. MAKE FINAL CONNECTION TO LOCK	
D-121	LEFT	SINGLE GANG	1	1	DOOR HARDWARE & PATHWAYS BY OTHERS. MAKE FINAL CONNECTION TO LOCK	
D-122	LEFT	SINGLE GANG	1	1	DOOR HARDWARE & PATHWAYS BY OTHERS. MAKE FINAL CONNECTION TO LOCK	
D-123	LEFT	SINGLE GANG	1	1	DOOR HARDWARE & PATHWAYS BY OTHERS. MAKE FINAL CONNECTION TO LOCK	
D-124	RIGHT	SINGLE GANG	1	1	DOOR HARDWARE & PATHWAYS BY OTHERS. MAKE FINAL CONNECTION TO LOCK	
D-125	LEFT	SINGLE GANG	1	1	DOOR HARDWARE & PATHWAYS BY OTHERS. MAKE FINAL CONNECTION TO LOCK	
D-126	LEFT	SINGLE GANG	1	1	DOOR HARDWARE & PATHWAYS BY OTHERS. MAKE FINAL CONNECTION TO LOCK	
D-127	LEFT/RIGHT	SINGLE GANG	1	0	DOOR HARDWARE & PATHWAYS BY OTHERS. MAKE FINAL CONNECTION TO LOCK	
D-128	LEFT/RIGHT	SINGLE GANG	1	0	DOOR HARDWARE & PATHWAYS BY OTHERS. MAKE FINAL CONNECTION TO LOCK	
D-129	LEFT	SINGLE GANG	1	1	DOOR HARDWARE & PATHWAYS BY OTHERS. MAKE FINAL CONNECTION TO LOCK	
D-130	RIGHT	SINGLE GANG	1	1	DOOR HARDWARE & PATHWAYS BY OTHERS. MAKE FINAL CONNECTION TO LOCK	
D-131	LEFT	SINGLE GANG	1	1	DOOR HARDWARE & PATHWAYS BY OTHERS. MAKE FINAL CONNECTION TO LOCK	
D-132	LEFT	SINGLE GANG	1	1	DOOR HARDWARE & PATHWAYS BY OTHERS. MAKE FINAL CONNECTION TO LOCK	
D-133	RIGHT	SINGLE GANG	1	1	DOOR HARDWARE & PATHWAYS BY OTHERS. MAKE FINAL CONNECTION TO LOCK	
D-134	LEFT	SINGLE GANG	1	1	DOOR HARDWARE & PATHWAYS BY OTHERS. MAKE FINAL CONNECTION TO LOCK	
D-135	LEFT	SINGLE GANG	1	1	DOOR HARDWARE & PATHWAYS BY OTHERS. MAKE FINAL CONNECTION TO LOCK	
D-136	LEFT	SINGLE GANG	1	1	DOOR HARDWARE & PATHWAYS BY OTHERS. MAKE FINAL CONNECTION TO LOCK	
D-137	LEFT	SINGLE GANG	1	1	DOOR HARDWARE & PATHWAYS BY OTHERS. MAKE FINAL CONNECTION TO LOCK	
D-138	RIGHT	SINGLE GANG	1	1	DOOR HARDWARE & PATHWAYS BY OTHERS. MAKE FINAL CONNECTION TO LOCK	
D-139	LEFT	SINGLE GANG	1	1	DOOR HARDWARE & PATHWAYS BY OTHERS. MAKE FINAL CONNECTION TO LOCK	
D-140	RIGHT	SINGLE GANG	1	1	DOOR HARDWARE & PATHWAYS BY OTHERS. MAKE FINAL CONNECTION TO LOCK	
D-141	LEFT	SINGLE GANG	1	1	DOOR HARDWARE & PATHWAYS BY OTHERS. MAKE FINAL CONNECTION TO LOCK	
D-142	LEFT	SINGLE GANG	1	1	DOOR HARDWARE & PATHWAYS BY OTHERS. MAKE FINAL CONNECTION TO LOCK	
D-143	LEFT	SINGLE GANG	1	1	DOOR HARDWARE & PATHWAYS BY OTHERS. MAKE FINAL CONNECTION TO LOCK	
D-144	LEFT/RIGHT	SINGLE GANG	1	0	DOOR HARDWARE & PATHWAYS BY OTHERS. MAKE FINAL CONNECTION TO LOCK	
D-145	LEFT	SINGLE GANG	1	1	DOOR HARDWARE & PATHWAYS BY OTHERS. MAKE FINAL CONNECTION TO LOCK	

**3 DOOR SCHEDULE**

**CONSTRUCTION NOTES**

- THE SCOPE OF WORK FOR THE PROJECT SHALL INCLUDE ALL LABOR, MATERIALS, DEVICES, SUPPLIES, EQUIPMENT, AND OTHER FACILITIES NECESSARY FOR AND INCIDENTAL TO THE EXECUTION AND COMPLETION OF WORK DESCRIBED IN THESE DOCUMENTS.
- THE CONTRACTOR SHALL SECURE AND PAY FOR THE BUILDING PERMIT AND OTHER PERMITS AND GOVERNMENT FEES, LICENSES AND INSPECTIONS NECESSARY FOR PROPER EXECUTION AND COMPLETION OF WORK.
- THE CONTRACTOR SHALL PAY ALL FEDERAL, STATE, LOCAL AND ALL OTHER TAXES THAT ARE APPLICABLE TO THIS CONTRACT.
- IT IS THE RESPONSIBILITY OF THE CONTRACTOR TO BECOME GENERALLY FAMILIAR WITH THE JOB SITE AND EXISTING CONDITIONS PRIOR TO PROCEEDING WITH WORK. THE CONTRACTOR SHALL VERIFY ALL DIMENSIONS AND CONDITIONS AT THE SITE AND REPORT ANY DISCREPANCIES TO THE DIRECTOR BEFORE PROCEEDING WITH THE WORK.
- THESE DRAWINGS AND DISCREPANCIES SHOULD BE CLARIFIED BY THE DRAWING SPECIFICATIONS. THE G.C. SHALL REQUEST WRITTEN INTERPRETATION FROM THE DIRECTOR BEFORE PROCEEDING WITH THAT PORTION OF THE WORK.**
- NO CHANGES, MODIFICATIONS OR DEVIATIONS SHALL BE MADE FROM THE DRAWINGS OR SPECIFICATIONS WITHOUT FIRST SECURING WRITTEN PERMISSION FROM THE ARCHITECT.
- ITEMS LABELED NC ARE "NOT IN CONTRACT". THE G.C., HOWEVER, IS RESPONSIBLE FOR ALL R.O., NECESSARY BLOCKING AND COORDINATION OF WORK.
- WHERE A SYSTEM OR ASSEMBLY IS CALLED FOR, ALL NECESSARY PARTS AND MATERIALS REQUIRED FOR A COMPLETE INSTALLATION/SYSTEM SHALL BE PROVIDED AND INSTALLED ACCORDING TO THE MANUFACTURERS INSTRUCTIONS.
- ALL SYSTEMS & MATERIALS SHALL BE INSTALLED IN STRICT ACCORDANCE WITH THE MANUFACTURERS RECOMMENDATIONS, INSTRUCTIONS AND SPECIFICATIONS.
- PROVIDE ADEQUATE CONCEALED BLOCKING AND ANCHORING FOR ALL CEILING AND WALL MOUNTED EQUIPMENT, HARDWARE AND ACCESSORIES. COORDINATE WITH ALL TRADES THE LOCATIONS OF SLEEVES, BLOCKING OR OTHER PRESET ACCESSORIES INVOLVING OTHER TRADES.
- CONTRACTOR TO COORDINATE AND SCHEDULE WORK OF ALL TRADES SO AS TO NOT DELAY AT ANY PHASE OF COMPLETION, CONSTRUCTION DUE TO INTERCONNECTING WORK OR LATE SCHEDULING. IT IS THE RESPONSIBILITY OF THE GENERAL CONTRACTOR TO ENSURE THAT ALL SUB-TRADES ARE FAMILIAR WITH THE COMPLETE CONSTRUCTION DOCUMENTS PACKAGE INCLUDING WORK THAT MAY OR MAY NOT BE PART OF THEIR SCOPE.
- ALL WORK SHALL BE PERFORMED WITH THE BEST ACCEPTED PRACTICES OF THE RESPECTED TRADES.
- ALL MATERIALS TO BE NEW (UNLESS OTHERWISE NOTED ON DRAWINGS), FIRST CLASS, IN EVERY RESPECT, AND SHALL CONFORM TO CONTRACT DOCUMENTS.
- CONTRACTOR TO COORDINATE CUTTING & PATCHING OF ALL TRADES MATCH EXISTING MATERIALS AS REQUIRED.
- CONTRACTOR TO COORDINATE KEYING SYSTEMS AND ALL HARDWARE FUNCTIONS WITH OWNER.
- CONTRACTOR TO COORDINATE THE INSTALLATION OF ALL ELECTRICAL, ALARM, SECURITY, DATA AND TELEPHONE LINES. CONCEAL ALL NEW UTILITIES IN FINISHED AREAS AS REQUIRED.
- LIFE SAFETY SYSTEMS SHALL BE INSTALLED AS REQUIRED, PER N.F.P.A., AND LOCAL REGULATIONS.
- CONTRACTOR TO COORDINATE ALL DELIVERY SCHEDULES AND LOCATIONS FOR ALL OWNER FURNISHED ITEMS WITH EACH SUPPLIER. VERIFY SUCH OWNER FURNISHED ITEMS WITH OWNERS REPRESENTATIVE. G.C. TO PROVIDE SOLID WOOD BLOCKING AS REQUIRED.
- CONTRACTOR SHALL REMOVE ALL TEMPORARY ITEMS, TRASH, TOOLS, AND EXCESS MATERIALS AT THE COMPLETION OF WORK AND LEAVE THE ENTIRE PROJECT SITE IN A NEAT, CLEAN, ACCEPTABLE CONDITION.
- PRIOR TO TURNING THE COMPLETED PROJECT OVER TO THE OWNER, THE CONTRACTOR SHALL REMOVE ALL GREASE, DUST, DIRT, STAINS, LABELS, FINGERPRINTS AND OTHER FOREIGN MATERIALS FROM SIGHT, AND SWEEP, WET-MOP AND VACUUM ALL FLOORS.
- THE CONTRACTOR SHALL PROVIDE TEMPORARY ELECTRICAL POWER AND LIGHTING AS REQUIRED.
- THE GENERAL CONTRACTOR SHALL MAINTAIN A SAFE AND SECURE SITE DURING ALL PHASES OF CONSTRUCTION.
- ALL WORK PERFORMED SHALL COMPLY WITH ALL FEDERAL, STATE AND LOCAL BUILDING CODES AND REQUIREMENTS, AS WELL AS THE MOST RECENT REQUIREMENTS OF THE APPLICABLE ACCESSIBILITY CODES.
- THE GENERAL CONTRACTOR SHALL SUBMIT A WRITTEN GUARANTEE FOR THEIR MATERIALS AND WORKMANSHIP FOR ONE (1) YEAR FROM THE DATE OF FINAL ACCEPTANCE BY OWNER.
- DISRUPTED ELECTRICAL AND WATER LINES RE-ROUTED DURING PROJECT CONSTRUCTION ARE TO REMAIN IN CONTINUOUS SERVICE.
- ANY EXISTING UTILITIES TO BE ABANDONED SHALL BE PROPERLY DISCONNECTED, PLUGGED OR CAPPED, AS REQUIRED BY CODE AND SOUND CONSTRUCTION PRACTICE.
- UNLESS OTHERWISE NOTED, ELECTRICAL CONDUITS, PLUMBING LINES, ETC., SHALL BE RUN CONCEALED AND FRAMING SHALL BE ADEQUATE SIZE TO ACCOMPLISH RESULT WITHOUT CAUSING ANY VARIATIONS IN THE WALL PLANE.



**Legend**

REVISION SET:	REVISION #:
STATUS:	PRELIMINARY

CLIENT:  
**CITY OF WHEELING**

SHEET TITLE:  
**SCHEDULE AND NOTES**

SCALE:	DATE:	DRAWN:	CHECKED:
NO SCALE	1/24/22	EAA	MG
PROJECT #:	SHEET #:	SCHEDULE	
73227			

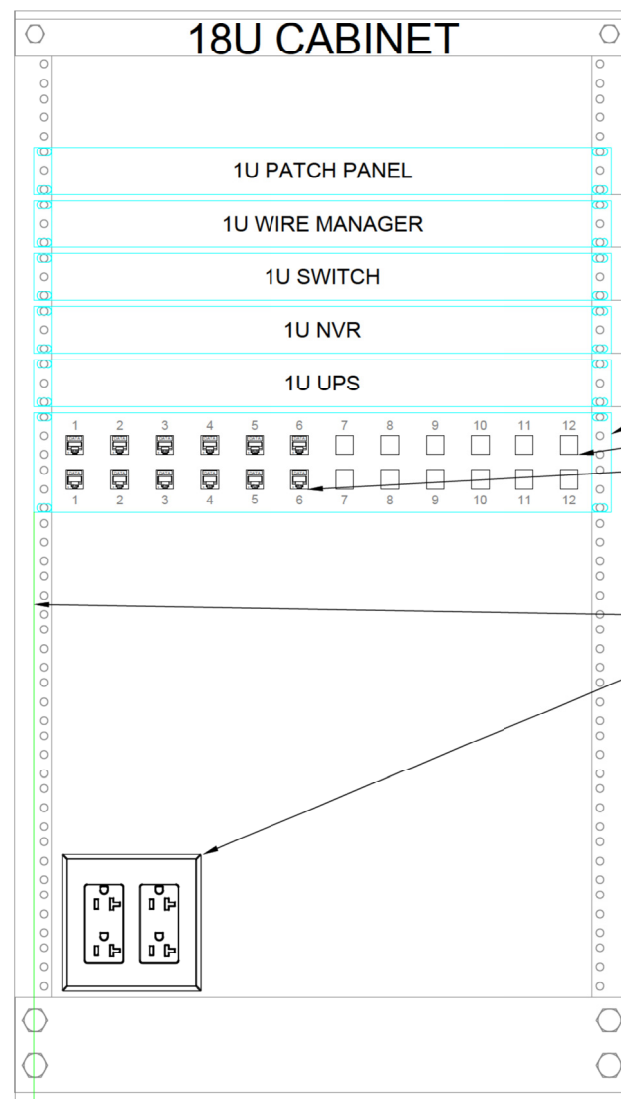

- OR-SPKFBU24 POPULATE W/ OR-KSFTP6 (SHIELDED)
- HORIZONTAL WIRE MANAGER AR8602A
- OS6350-PIO W/ 19" RM W/PP5N-OS6350 5-YR SUPPORT
- SV-1011E-R2-8T-22G-8TB STREAMVAULT SERVER
- PR1000LCDRT1U 1000VA/800W SINE WAVE UPS
- DTK-VM12RM
- DTK-RM12FPPLUG
- DTK-VM45POE (1) PER EXTERIOR CAMERA

- (1) GROUND WIRE 10AWG MIN. TO TGB BUSBAR
- (1) QUAD RECPTICAL 120V/20A
- GL36WDM-B-AF 18U, MESH DOOR AND FAN KIT

NOTES:  
 EXTEND 110VAC PWR TO WALL CABINET AND ACCESS CONTROL POWER SUPPLY. CONFIRM CIRCUIT HAS SUFFICIENT CAPACITY ADD BREAKER IF NO OPEN CIRCUITS ARE AVAILABLE.

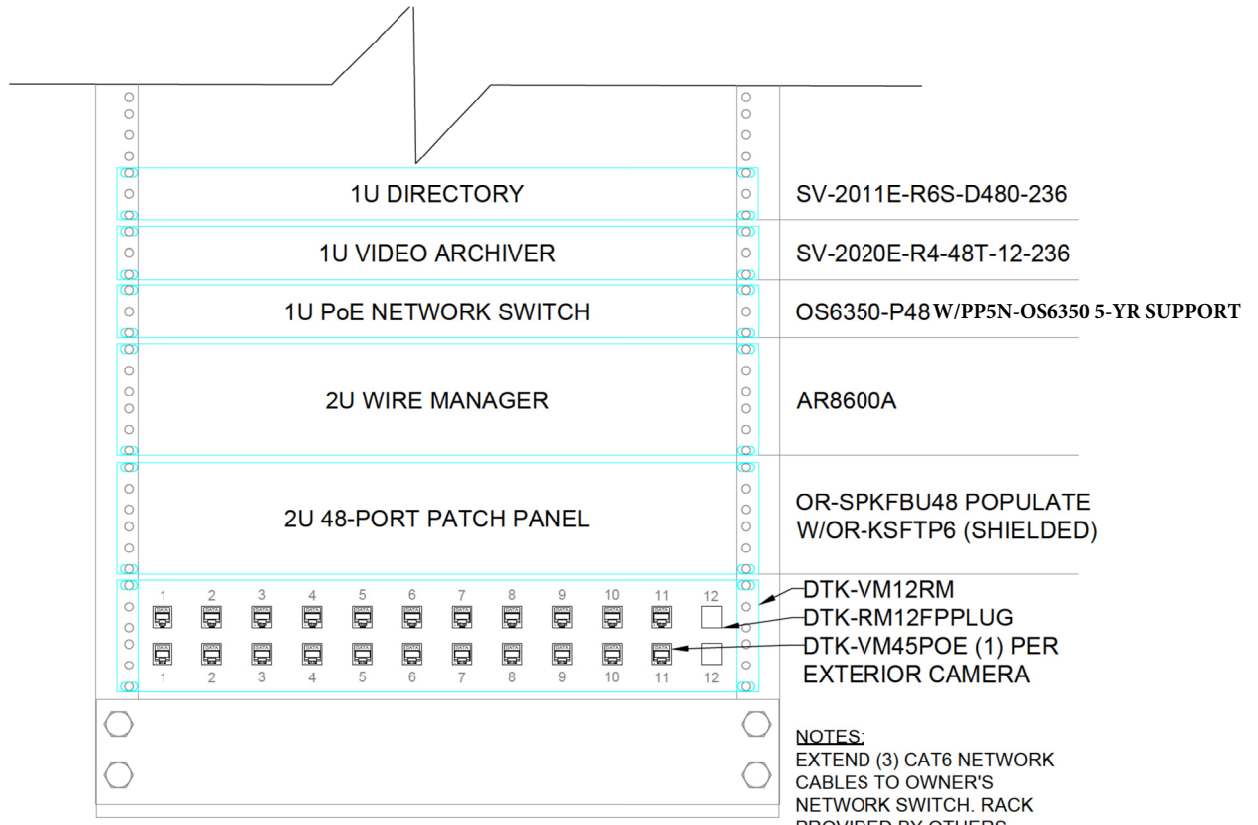

- SV-2011E-R6S-D480-236
- SV-2020E-R4-48T-12-236
- OS6350-P48 W/PP5N-OS6350 5-YR SUPPORT
- AR8600A
- OR-SPKFBU48 POPULATE W/OR-KSFTP6 (SHIELDED)
- DTK-VM12RM
- DTK-RM12FPPLUG
- DTK-VM45POE (1) PER EXTERIOR CAMERA

NOTES:  
 EXTEND (3) CAT6 NETWORK CABLES TO OWNER'S NETWORK SWITCH. RACK PROVIDED BY OTHERS.

Legend

1 TYPICAL FIRE STATION RACK LAYOUT

NOT TO SCALE

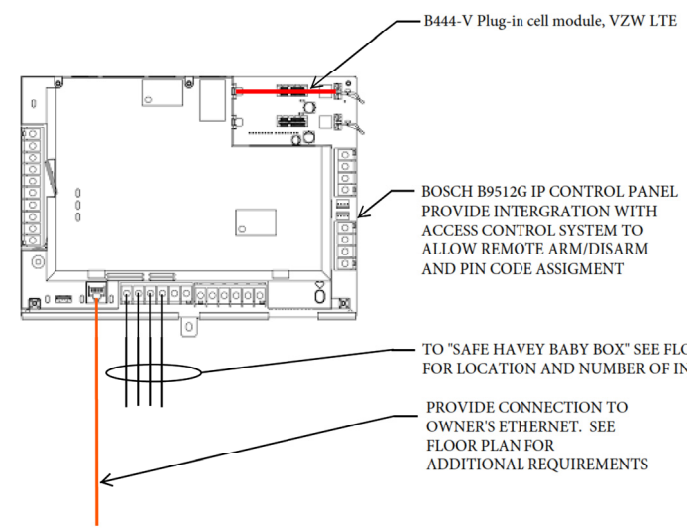

BOSCH B9512G IP CONTROL PANEL PROVIDE INTERGRATION WITH ACCESS CONTROL SYSTEM TO ALLOW REMOTE ARM/DISARM AND PIN CODE ASSIGNMENT

TO "SAFE HAVEY BABY BOX" SEE FLOOR PLAN FOR LOCATION AND NUMBER OF INPUTS

PROVIDE CONNECTION TO OWNER'S ETHERNET. SEE FLOOR PLAN FOR ADDITIONAL REQUIREMENTS

4 ALARM CONTROL PANEL I.T. SERVER ROOM-147

NOT TO SCALE

ID	PURPOSE	DESCRIPTION
C1	CARD READER	8-COND. #22AWG STR./SHLD.
C2	LOCK POWER	2-COND. #18AWG STR./SHLD.
C3	MAGNETIC LOCK SIGNAL	6-COND. #22AWG STR./SHLD.
C4	EXIT PUSHBUTTON	4-COND. #18AWG STR./SHLD.
C5	PROP SOUNDER	2-COND. #18AWG STR./SHLD.
C6	ADA ACTUATOR	4-COND. #18AWG STR./SHLD.
C7	ADA OPERATOR CONTROL	2-COND. #18AWG STR./SHLD.
C8	ELECTRONIC MORTISE LOCK	6-COND. #18AWG STR./SHLD.
C9	ALARM LOCK	10-COND. #22AWG STR./SHLD.
C10	REX BAR	4-COND. #18AWG STR./SHLD.
C11	EXIT DEVICE TRIM RELEASE	2-COND. #18AWG STR./SHLD.
C12	RTE AND BOLT POSITION SENSE	4-COND. #22AWG STR./SHLD.
C13	MONITOR STRIKE	4-COND. #22AWG STR./SHLD.
C14	DOOR SWITCH	4-COND. #22AWG STR./SHLD.
C15	DOOR MOTION DETECTOR RTE	4-COND. #22AWG STR./SHLD.
C16	MOTION DETECTOR PWR & RTE	4-COND. #22AWG STR./SHLD.
C17	ELR DEVICE POWER	2- #12AWG STR. (MAX. 200')
C18	IDS ARMING STATION	6-COND. #22AWG STR./SHLD.
C19	FLVATOR CAI 1 BUTTON	2-COND. #18AWG STR./SHLD.
C20	DIGITAL VOICE ALARM	10-COND. #22AWG STR./SHLD.
C21	SPARE CONTROL CABLE (NOTE 1)	2-COND. #18AWG STR./SHLD.
C22	SPARE SIGNAL CABLE (NOTE 1)	6-COND. #22AWG STR./SHLD.
C23	INTERCOM STATION	CAT 6

3 TYPICAL DOOR LAYOUT

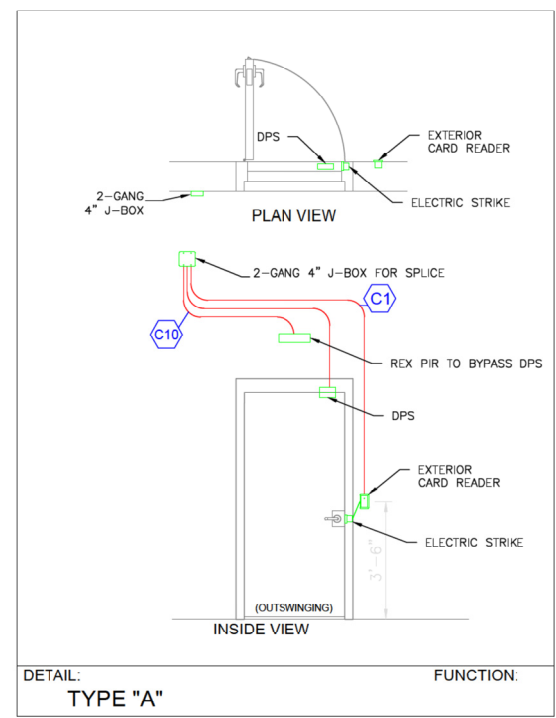

DETAIL: TYPE "A" FUNCTION.

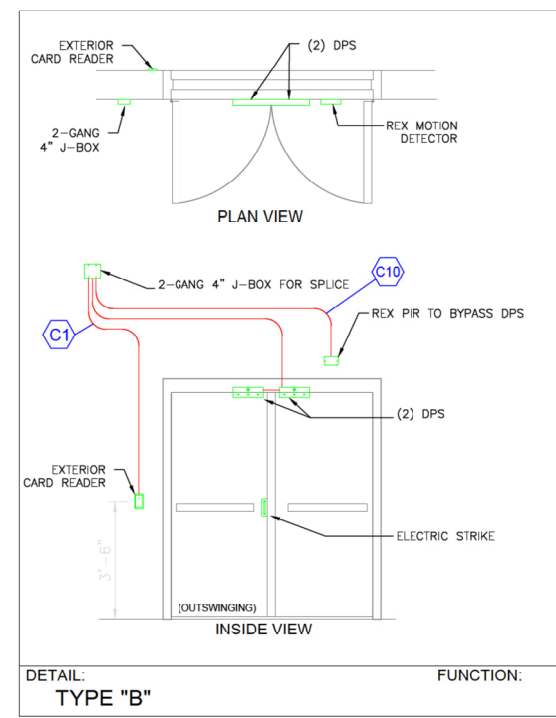

DETAIL: TYPE "B" FUNCTION.

REVISION SET: ---	REVISION #: ---
STATUS: PRELIMINARY	

CLIENT: CITY OF WHEELING

SHEET TITLE: TYPICAL LAYOUTS

SCALE: NO SCALE	DATE: 1/24/22	DRAWN: EAA	CHECKED: MG
PROJECT #: 73227	SHEET #: LAYOUTS		

NOT TO SCALE

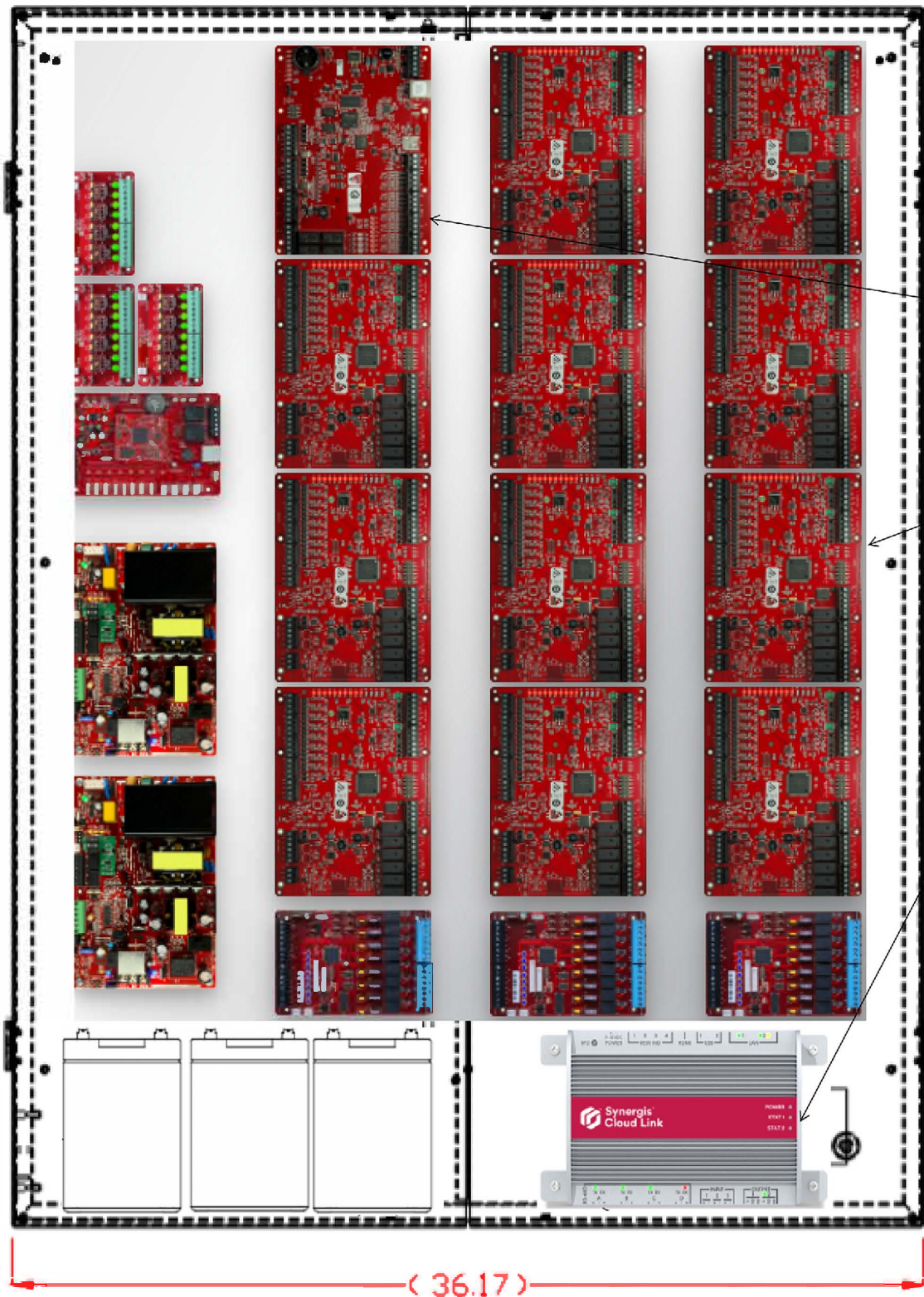

1 TYPICAL HQ ACCESS CONTROL PANEL

NOT TO SCALE

FPO150-B100D8PM8NL4E4M

FPO250/250-3D8P3M8NLXE12M

SY-I.P1502

SY-MR52-S3

SY-CLOUDLINK

12V 7AH BATTERY

1 TYPICAL STATION ACCESS CONTROL PANEL

NOT TO SCALE

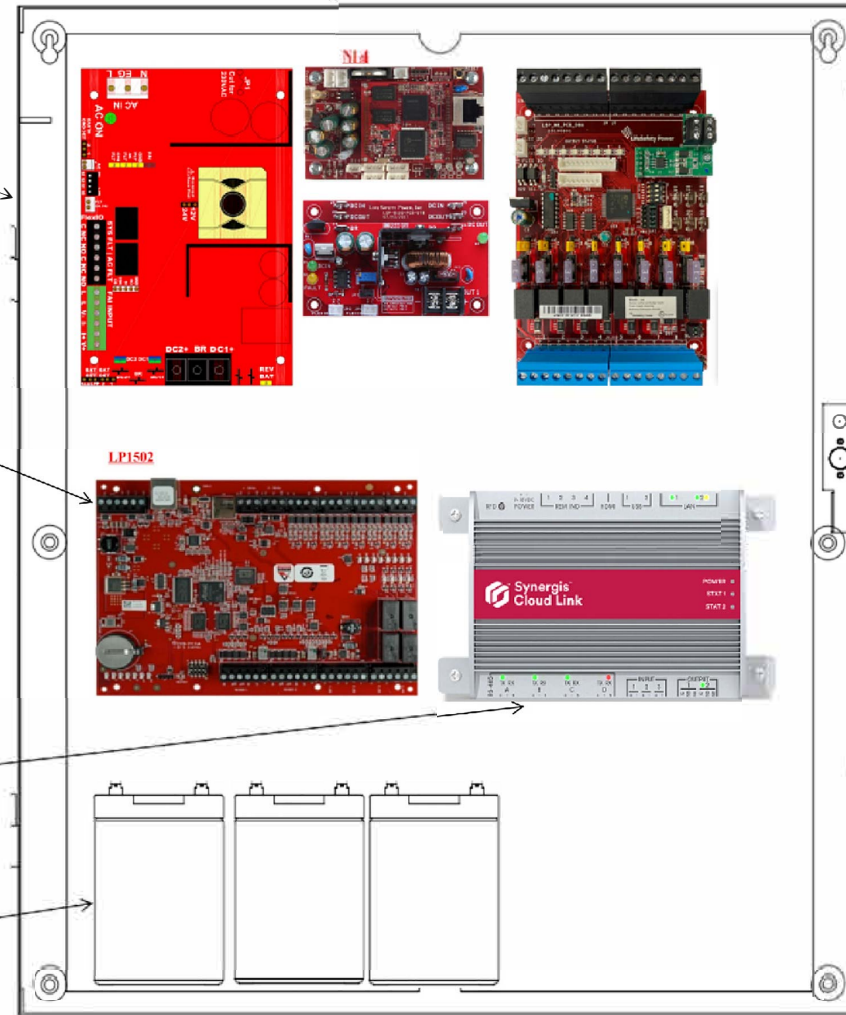

DISCLAIMER:

Legend

REVISION SET:	REVISION #
---	---
STATUS	
PRELIMINARY	

CLIENT
CITY OF WHEELING

SHEET TITLE
TYPICAL LAYOUTS

SCALE:	DATE:	DRAWN:	CHECKED:
NO SCALE	1/12/22	EAA	MG
PROJECT #:	SHEET #:		
73227	LAYOUTS		

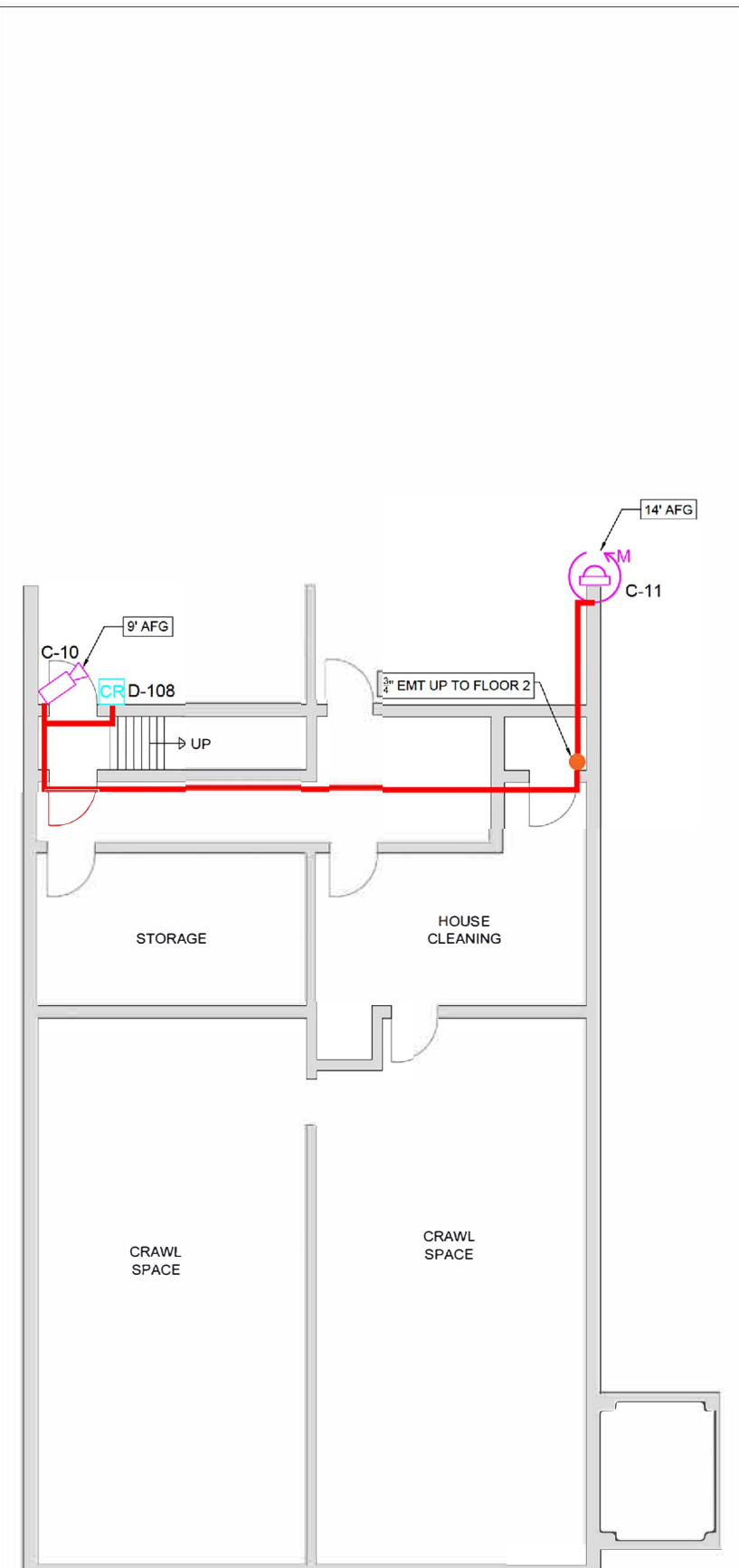

**B** STATION 2-BASEMENT PLAN-SECURITY NO SCALE

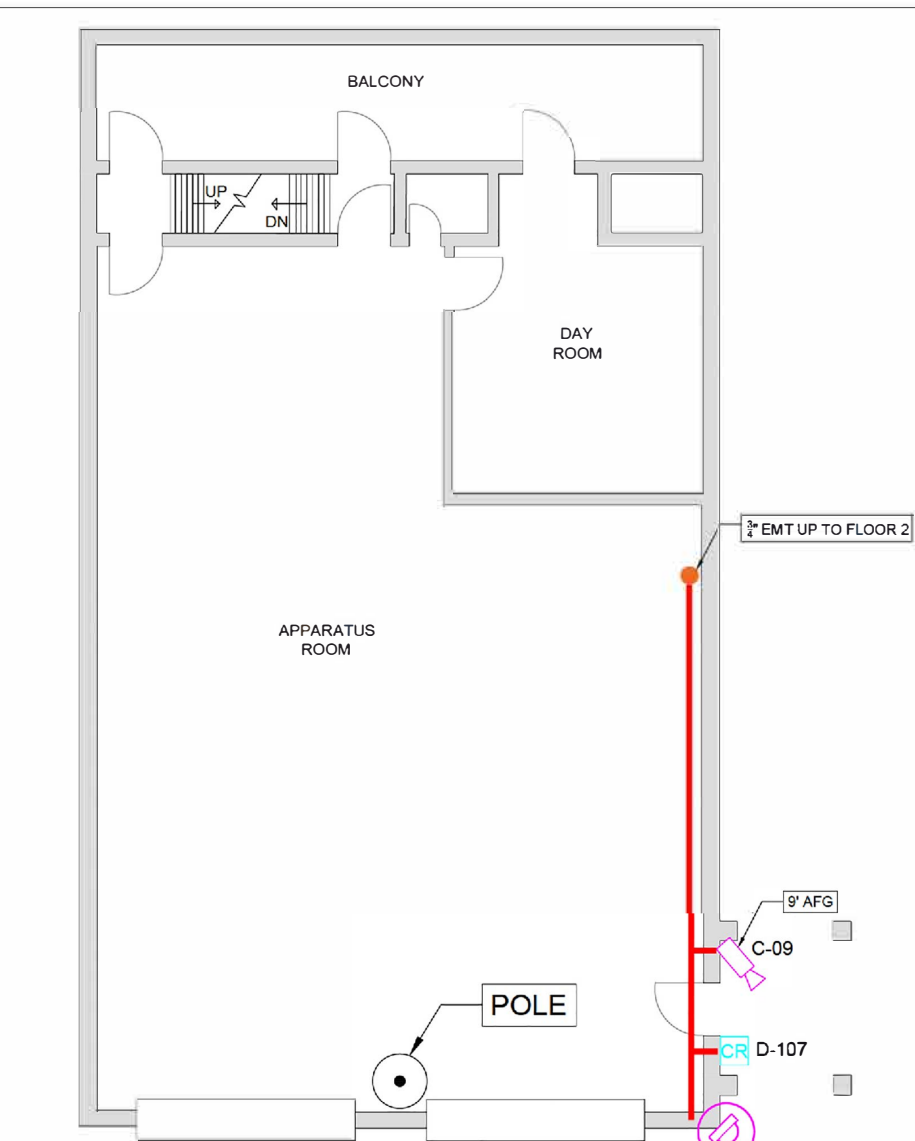



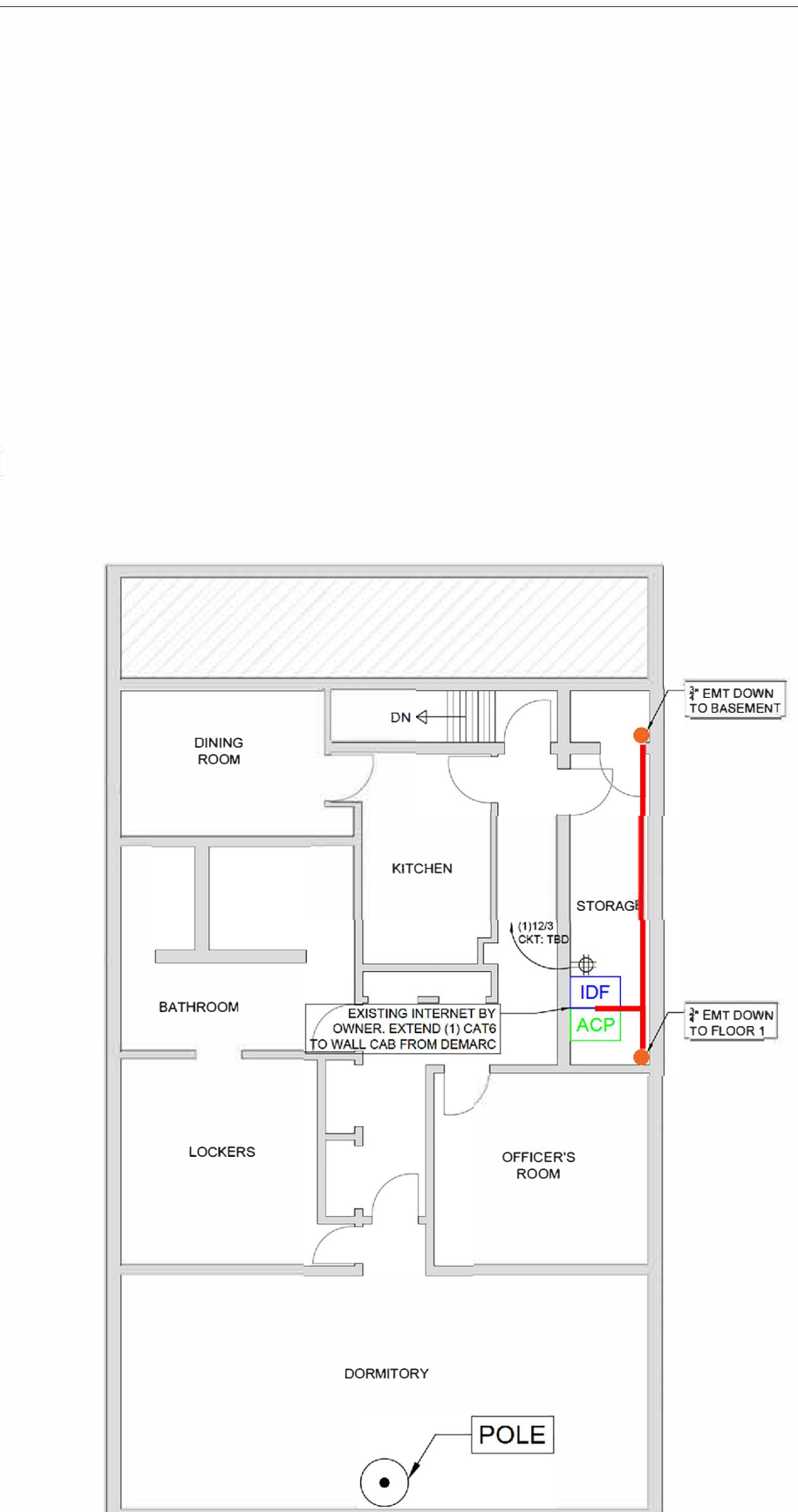

**1** STATION 2-FIRST FLOOR PLAN-SECURITY NO SCALE



**2** STATION 2-SECOND FLOOR PLAN-SECURITY NO SCALE



-  MULTI-SENSOR CAMERA
-  CAMERA
-  CARD READER
-  ACCESS CONTROL PANEL
-  3/4" EMT

REVISION SET:	REVISION #

STATUS: PRELIMINARY

CLIENT: CITY OF WHEELING

SHEET TITLE:  
**FIRE STATION 2  
 801 MAIN ST.  
 WHEELING, WV 26003**

SCALE: NO SCALE	DATE: 1/24/22	DRAWN: EAA	CHECKED: MG
--------------------	------------------	---------------	----------------

PROJECT #: 73227	SHEET #: STATION 2
---------------------	-----------------------

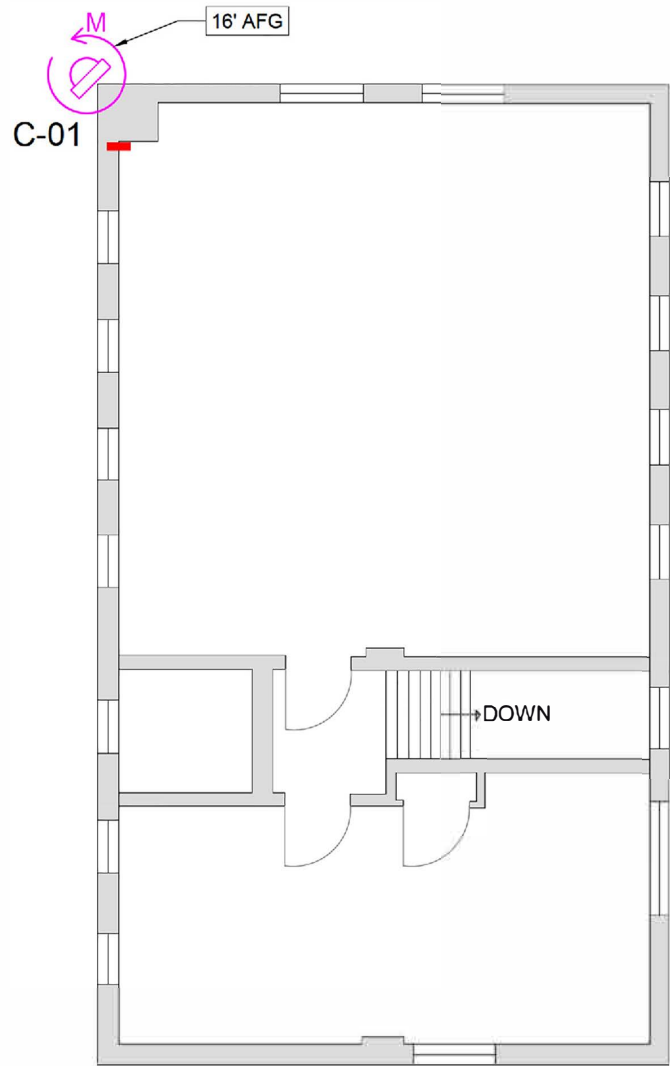

2 STATION 4-SECOND FLOOR-SECURITY

NO SCALE

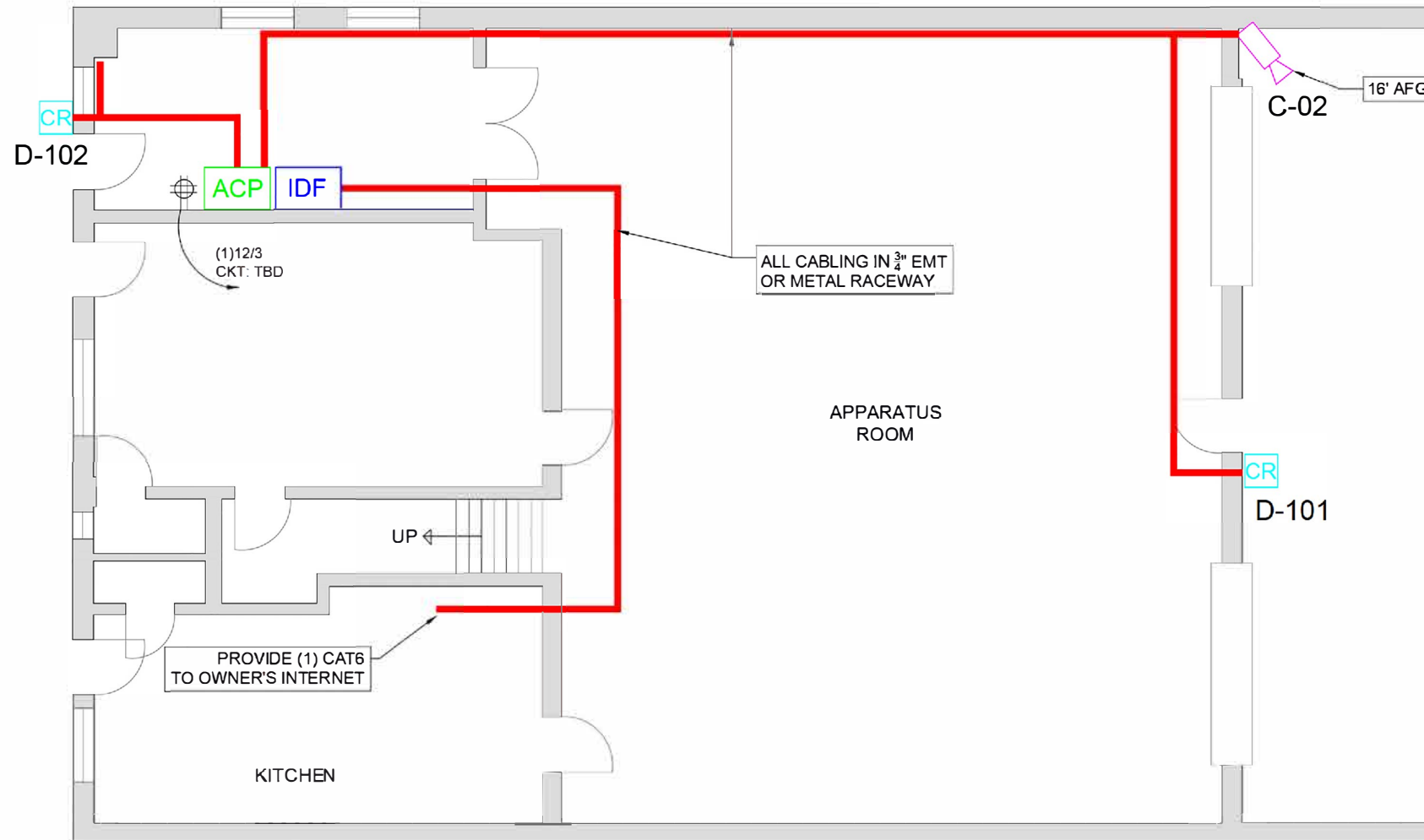





1 STATION 4-FIRST FLOOR-SECURITY

NO SCALE

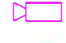
DISCLAIMER:

Legend

-  MULTI-SENSOR CAMERA
-  CAMERA
-  CARD READER
-  ACCESS CONTROL PANEL
-  3/4" EMT

REVISION SET:	REVISION #
----	----

STATUS:	PRELIMINARY
---------	-------------

CLIENT:  
**CITY OF WHEELING**

SHEET TITLE:  
**FIRE STATION 4  
3618 JACOB ST.  
WHEELING, WV 26003**

SCALE:	DATE:	DRAWN:	CHECKED:
NO SCALE	1/24/22	EAA	MG

PROJECT #:	SHEET #:
73227	STATION 4

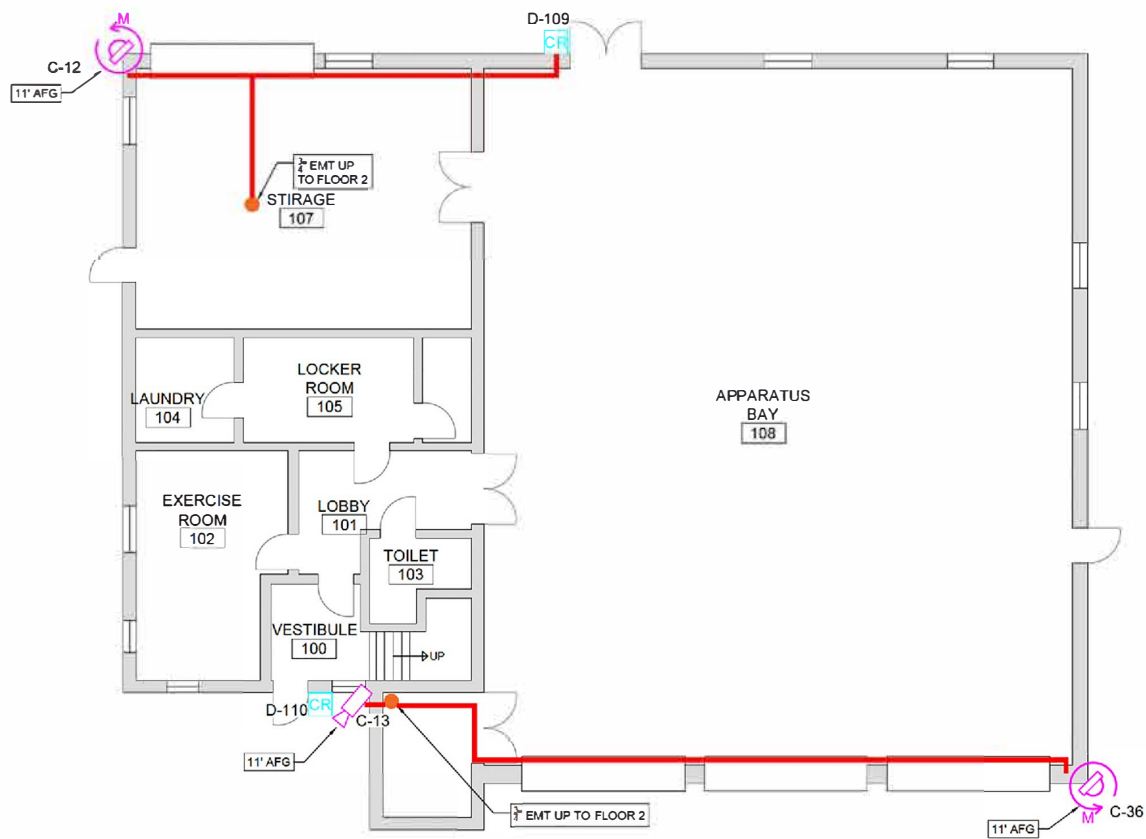



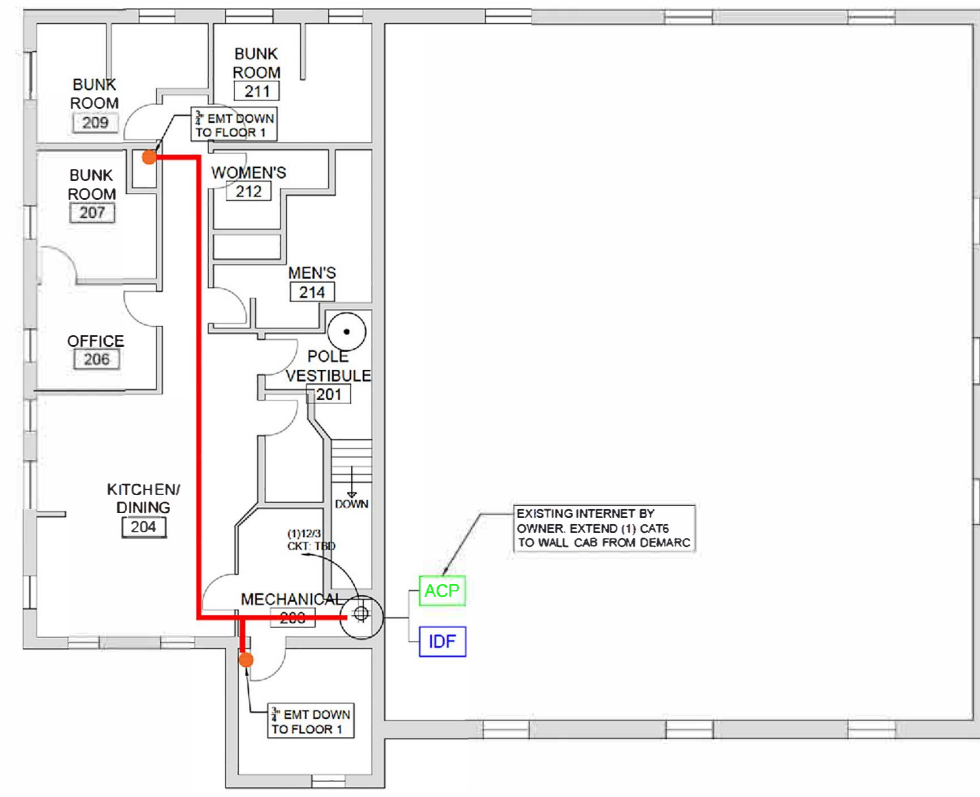

1 STATION 5-FIRST FLOOR-SECURITY NO SCALE



2 STATION 5-SECOND FLOOR-SECURITY NO SCALE



-  MULTI-SENSOR CAMERA
-  CAMERA
-  CARD READER
-  ACCESS CONTROL PANEL
-  3/4" EMT

REVISION SET:	REVISION #
---	---
STATUS:	
PRELIMINARY	

CLIENT:

**CITY OF WHEELING**





SHEET TITLE:

**FIRE STATION 5  
11 NORTH WABASH ST.  
WHEELING, WV 26003**

SCALE:	DATE:	DRAWN:	CHECKED:
NO SCALE	1/24/22	EAA	MG
PROJECT #:	SHEET #		
73227	STATION 5		

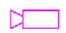

**Legend**

	MULTI-SENSOR CAMERA
	CAMERA
	CARD READER
	ACCESS CONTROL PANEL
	3/4" EMT

REVISION SET: _____	REVISION #: _____		
STATUS: PRELIMINARY			
CLIENT: CITY OF WHEELING			
SHEET TITLE: FIRE STATION 9 1301 RICHLAND AVE. WHEELING, WV 26003			
SCALE: NO SCALE	DATE: 1/24/22	DRAWN: EAA	CHECKED: MG
PROJECT #: 73227	SHEET #: STATION 9		

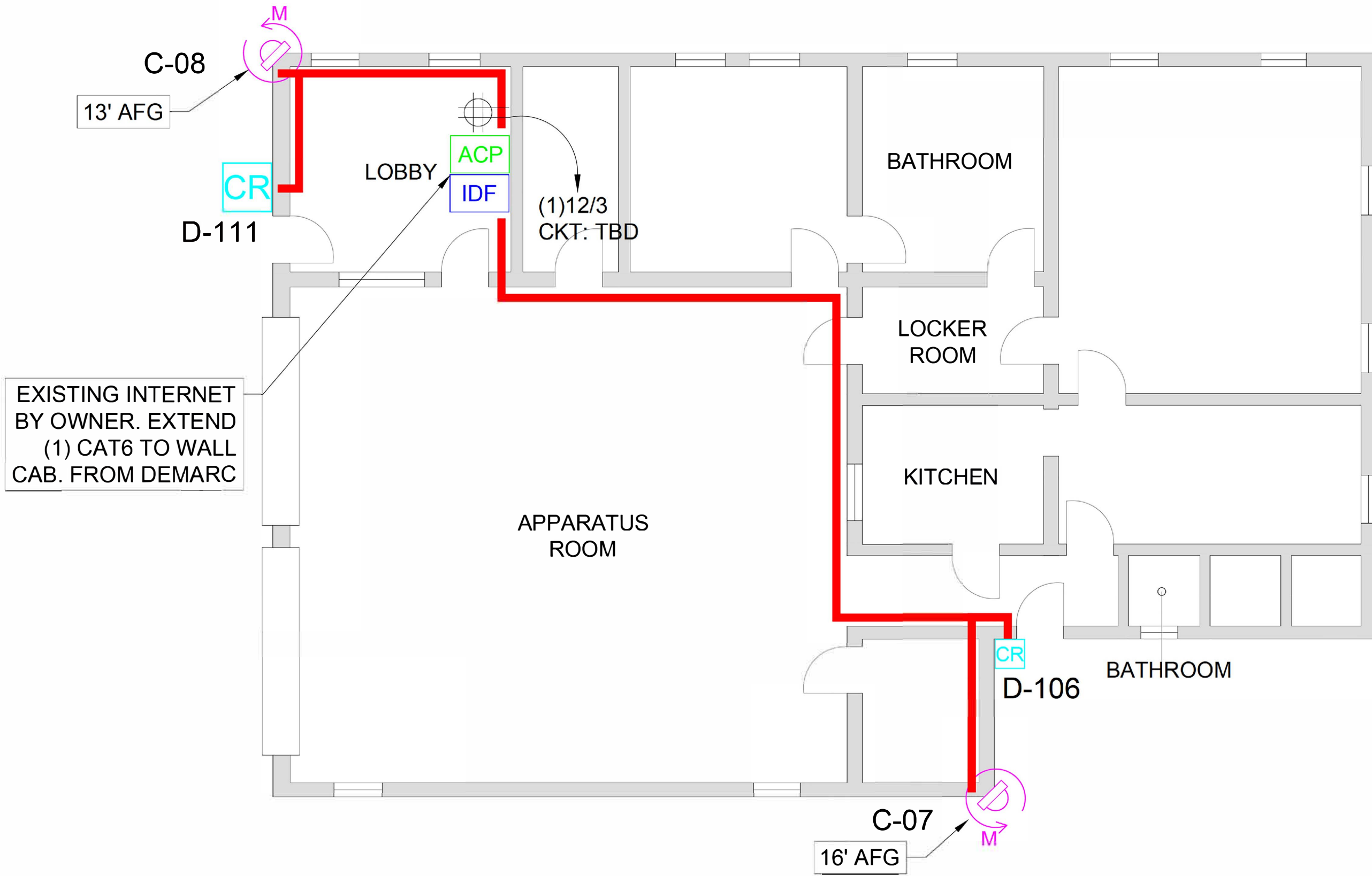

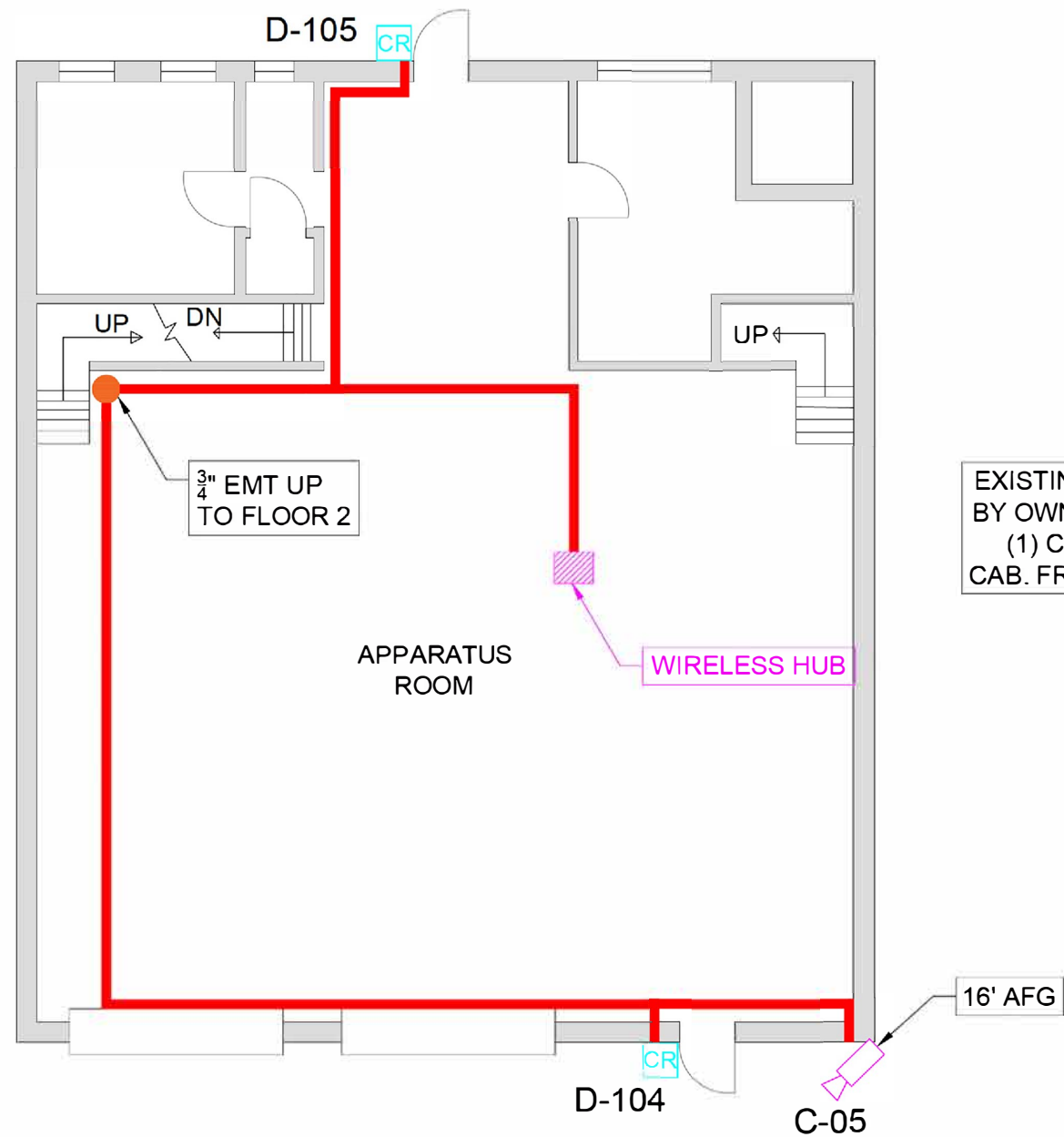

EXISTING INTERNET BY OWNER. EXTEND (1) CAT6 TO WALL CAB. FROM DEMARC

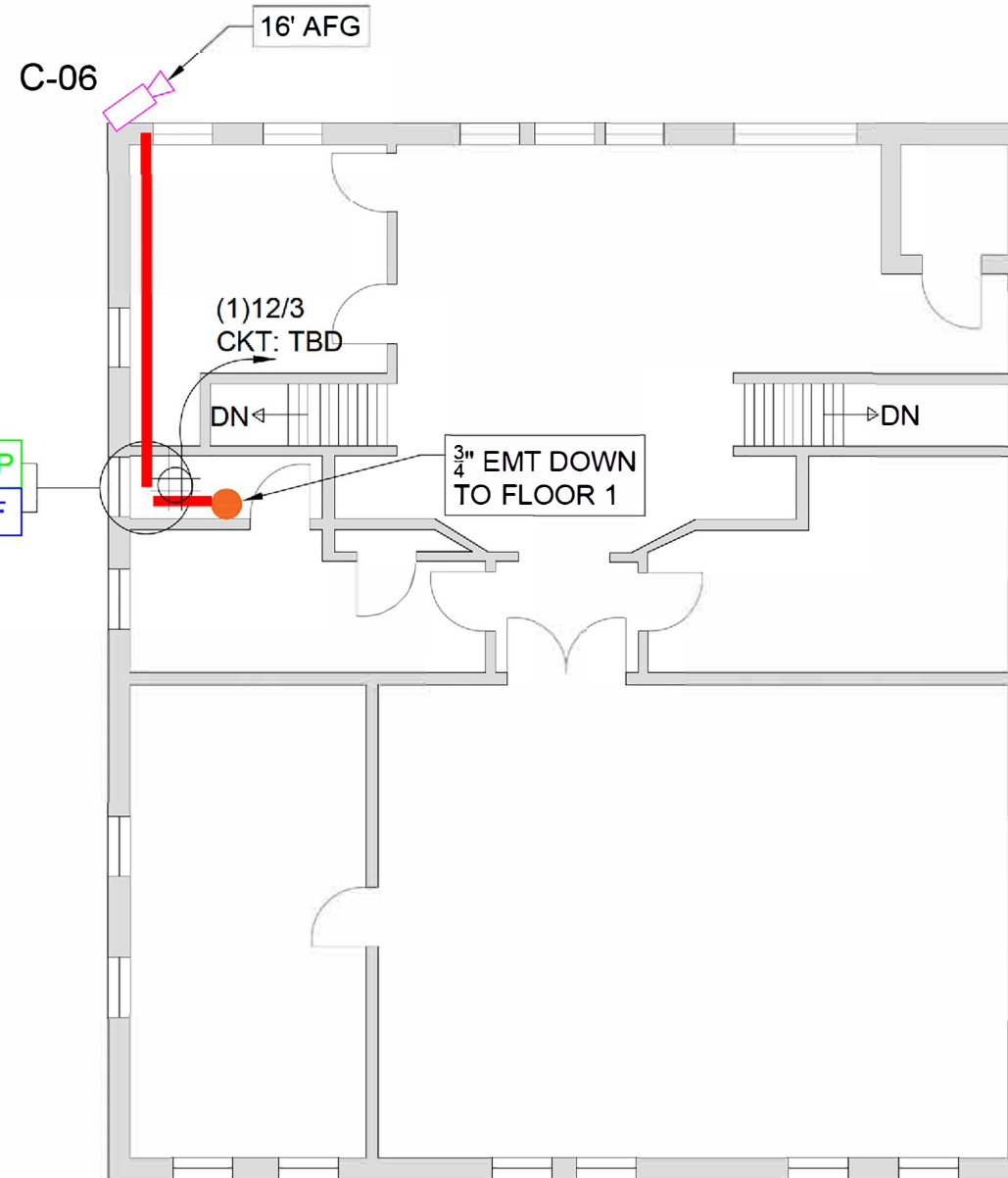
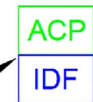

- Legend
- MULTI-SENSOR CAMERA
  - CAMERA
  - CARD READER
  - ACCESS CONTROL PANEL
  - 3/4" EMT

1 STATION 10-FIRST FLOOR PLAN-SECURITY

NO SCALE

2 STATION 10-SECOND FLOOR PLAN-SECURITY

NO SCALE

REVISION SET:	REVISION #
----	----

STATUS:	PRELIMINARY
---------	-------------

CLIENT:	CITY OF WHEELING
---------	------------------

SHEET TITLE:	FIRE STATION 10 298 POPLAR AVE. WHEELING, WV 26003
--------------	--

SCALE:	DATE:	DRAWN:	CHECKED:
NO SCALE	1/24/22	EAA	MG

PROJECT #:	SHEET #:
73227	STATION 10



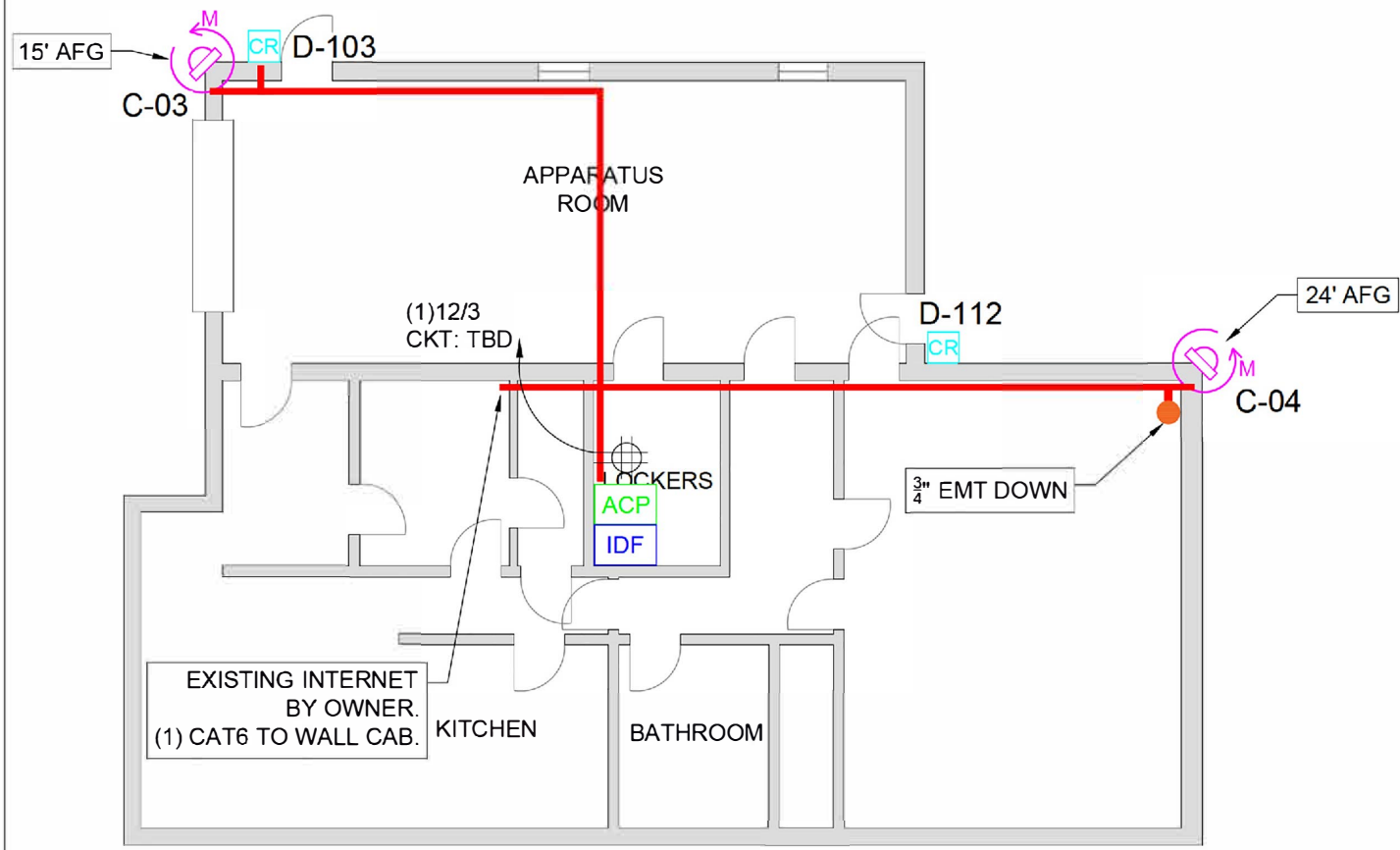

1 STATION 11-FIRST FLOOR

NO SCALE

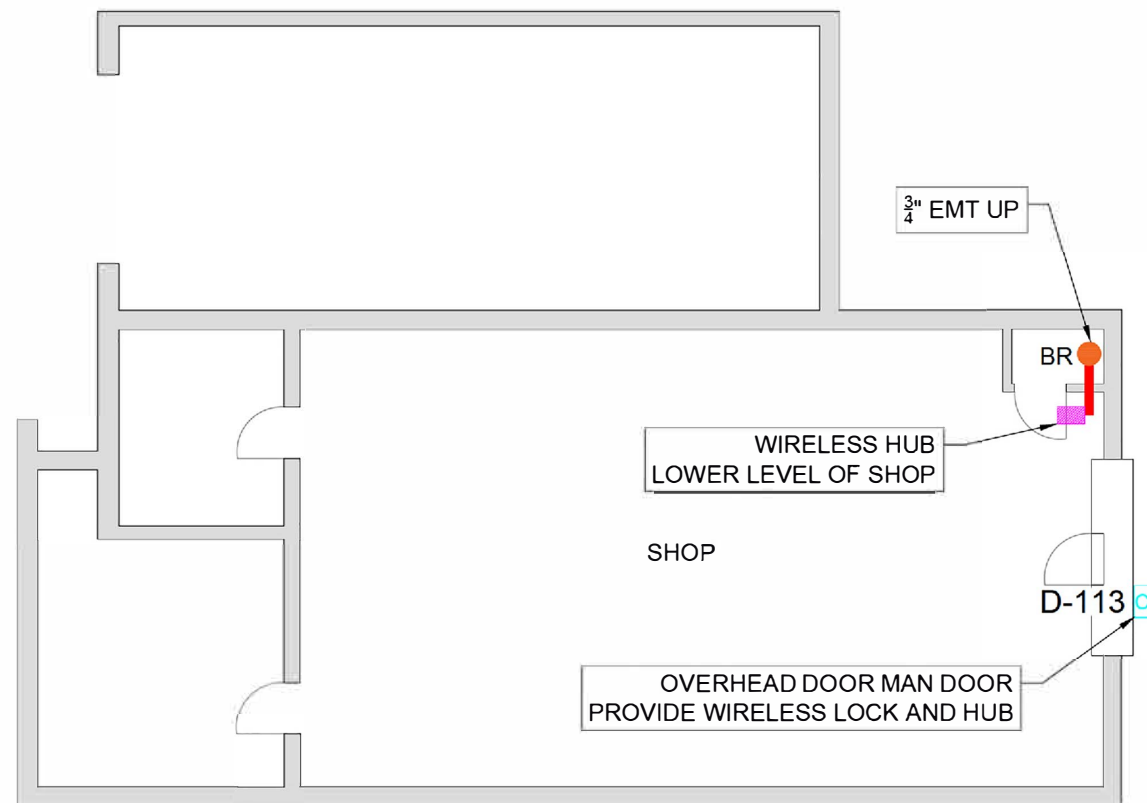





2 STATION 11-LOWER LEVEL

NO SCALE

DISCLAIMER:

Legend

-  MULTI-SENSOR CAMERA
-  CAMERA
-  CARD READER
-  ACCESS CONTROL PANEL
-  3/4" EMT

REVISION SET:	REVISION #
----	----

STATUS:	PRELIMINARY
---------	-------------

CLIENT:	CITY OF WHEELING
---------	------------------

SHEET TITLE:	FIRE STATION 11 139 EAST BETHLEHEM BLVD. WHEELING, WV 26003
--------------	---

SCALE:	DATE:	DRAWN:	CHECKED:
NO SCALE	1/24/22	EAA	MG





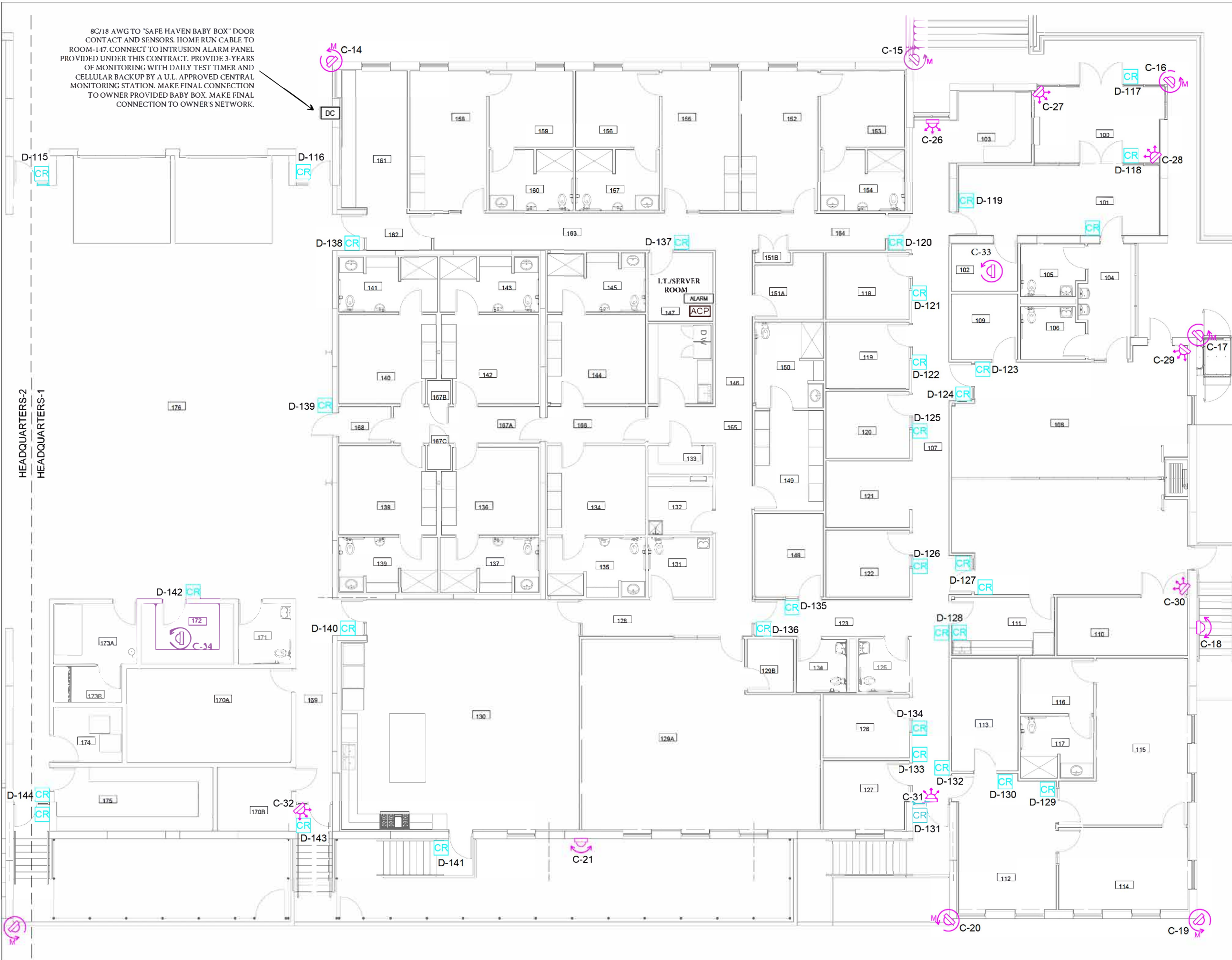

PROJECT #:	SHEET #
73227	STATION 11

8C/18 AWG TO "SAFE HAVEN BABY BOX" DOOR CONTACT AND SENSORS. HOME RUN CABLE TO ROOM-147. CONNECT TO INTRUSION ALARM PANEL PROVIDED UNDER THIS CONTRACT. PROVIDE 3-YEARS OF MONITORING WITH DAILY TEST TIMER AND CELLULAR BACKUP BY A U.L. APPROVED CENTRAL MONITORING STATION. MAKE FINAL CONNECTION TO OWNER PROVIDED BABY BOX. MAKE FINAL CONNECTION TO OWNER'S NETWORK.



DISCLAIMER:

Legend

-  MULTI-SENSOR CAMERA
-  360° CAMERA
-  180° CAMERA
-  FIXED CAMERA
-  CARD READER
-  ALARM CONTROL PANEL
-  ACCESS CONTROL PANEL

REVISION SET: \_\_\_\_\_ REVISION #: \_\_\_\_\_

STATUS: PRELIMINARY

CLIENT: CITY OF WHEELING

SHEET TITLE: W.F.D. FIRE HEADQUARTERS  
17TH STREET  
WHEELING, WV 26003

SCALE: NO SCALE	DATE: 1/24/22	DRAWN: EAA	CHECKED: MG
--------------------	------------------	---------------	----------------

PROJECT #: 73227	SHEET #: HEADQUARTERS-1
---------------------	----------------------------

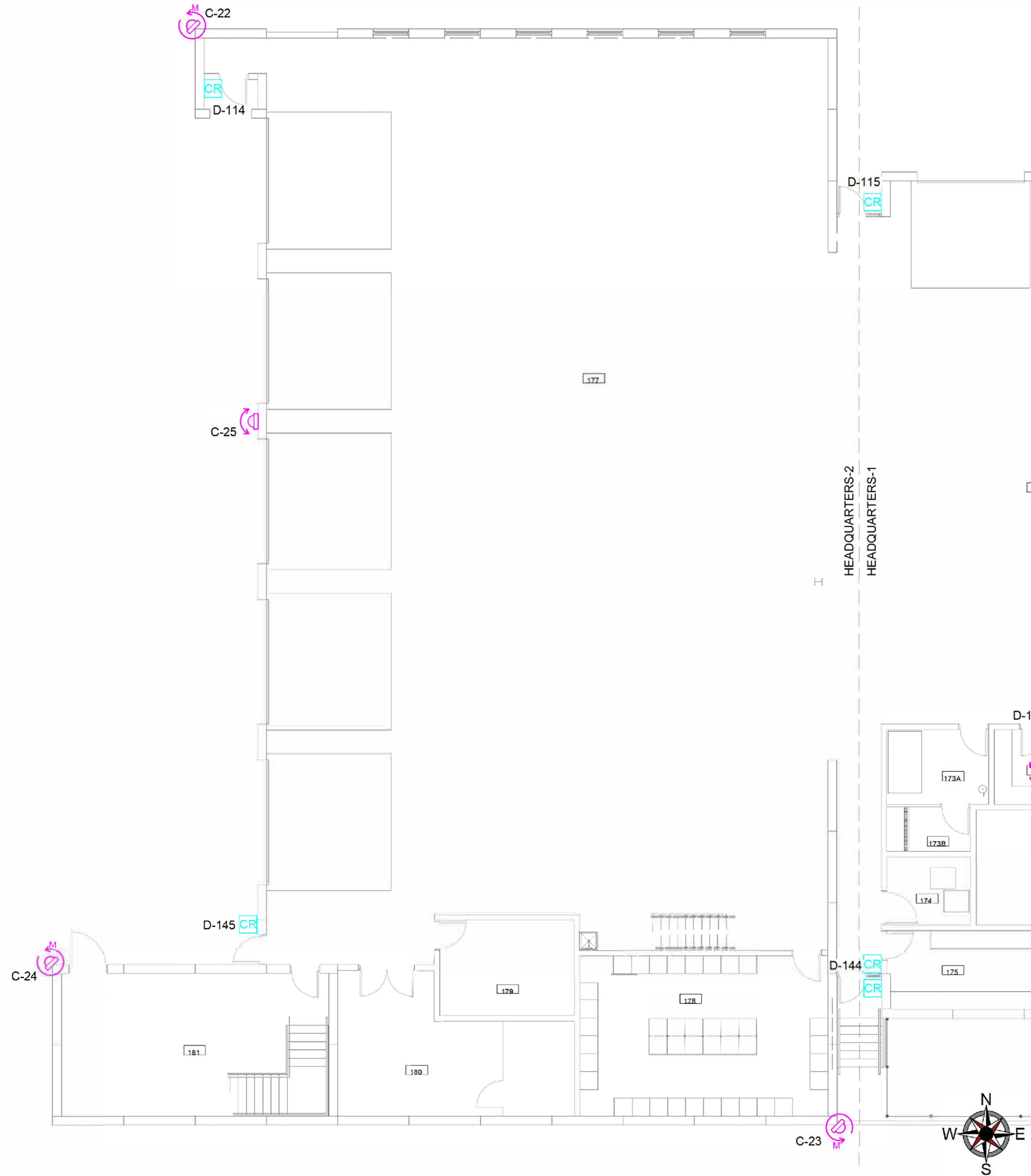





C-37

POLE MOUNTED CAMERA. REFER TO ARCHITECTURAL DRAWINGS FOR EXACT LOCATION. ASSUME 300' OF SHIELDED OUTDOOR RATED CAT6 CABLE WITH LIGHTING SURGE PROTECTION ON BOTH ENDS. UNDERGROUND CONDUIT AND POLE SUPPLIED BY OTHERS.



Legend

-  MULTI-SENSOR CAMERA
-  360° CAMERA
-  180° CAMERA
-  CARD READER

REVISION SET:	REVISION #
STATUS:	PRELIMINARY

CLIENT:  
**CITY OF WHEELING**

SHEET TITLE:  
**W.F.D. FIRE HEADQUARTERS  
17TH STREET  
WHEELING, WV 26003**

SCALE: NO SCALE	DATE: 1/24/22	DRAWN: EAA	CHECKED: MG
PROJECT #: 73227	SHEET #: HEADQUARTERS-2		